

Details are INDICATIVE ONLY and need to be made project specific.

While reasonable care has been taken to ensure that the information included in this drawing was accurate at the time of issue, we reserve the right to change specifications at any time. Final detailing remains the responsibility of the designer due to site & client specific requirements.

Do not scale from this drawing.

Drawing to be read in conjunction with all standard series drawings

Wood frame and bracing requirements to architect's specification

Recess all windows and doorways from the finished face by a minimum of 4"

Proprietary expanding tape around perimeter of window for air tightness

All structural fasteners to be non-ferrous, any galvanized fasteners to be painted with red oxide primer or bitumen paint.

Generic frame seal bead at junction of render and window for waterproofing

Stainless steel or UPVC corner beading

5/8" Baunit FL68 Lime Render direct to Tradical® Hemcrete®

External Finish:
1/8" Pre-colored Baunit SEP Lime Render Top Coat

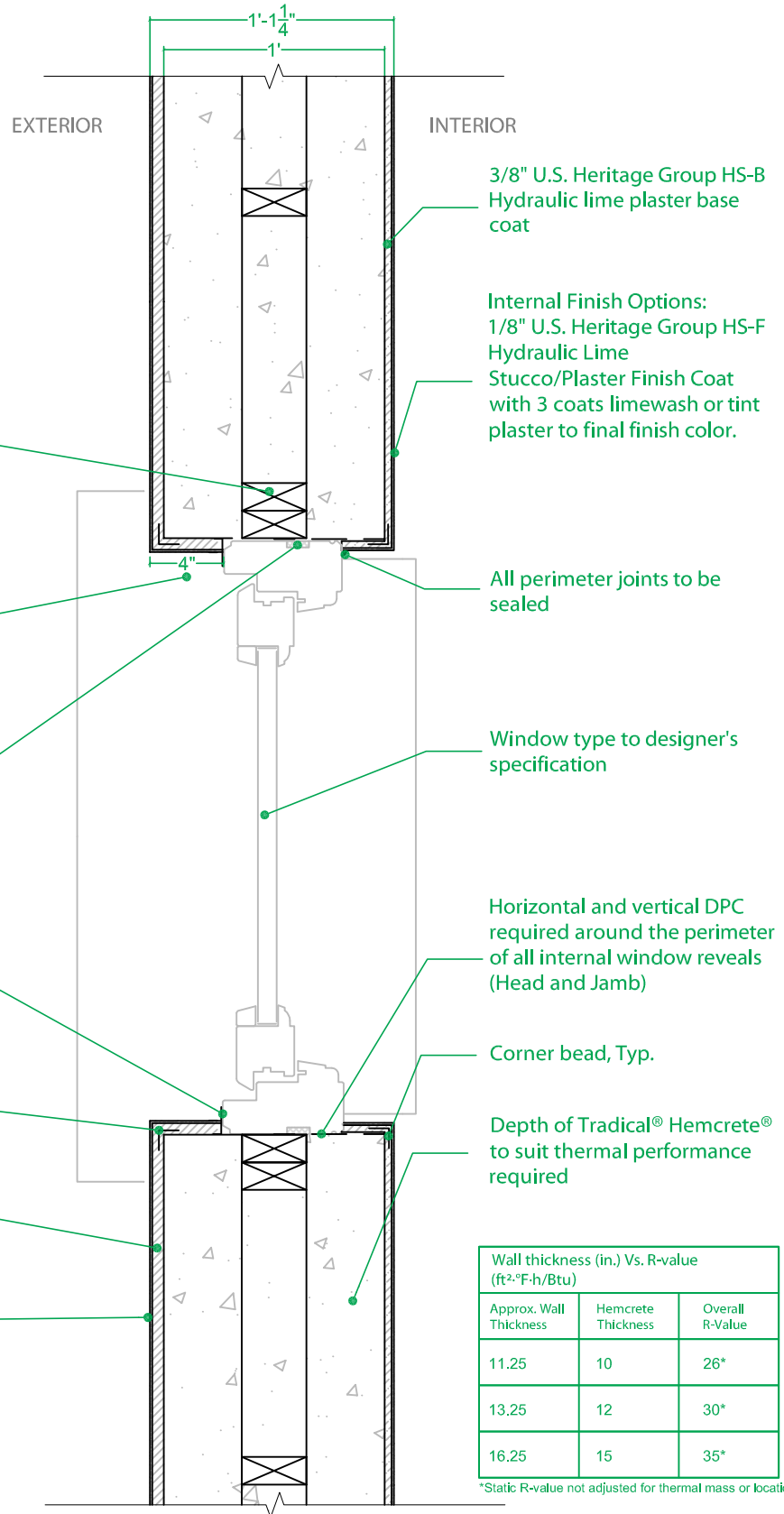

Wall thickness (in.) Vs. R-value (ft ² ·F·h/Btu)		
Approx. Wall Thickness	Hemcrete Thickness	Overall R-Value
11.25	10	26*
13.25	12	30*
16.25	15	35*

*Static R-value not adjusted for thermal mass or location

12.11	US Conversion	UK File Name	DWN	CKD
	ALT]TradHem]Render]STD_WIN_PLAN	1_10_A4_LMT		
			JK	DW