

Details are INDICATIVE ONLY and need to be made project specific.

While reasonable care has been taken to ensure that the information included in this drawing was accurate at the time of issue, we reserve the right to change specifications at any time. Final detailing remains the responsibility of the designer due to site & client specific requirements.

Do not scale from this drawing.

Drawing to be read in conjunction with all standard series drawings

Rafter depths to architect's specification.

Warm roof design and roof finish to the designer's specification

Line indicates Hemcrete® density change from the wall mix to roof mix

All structural fasteners to be non-ferrous, any galvanized fasteners to be painted with red oxide primer or bitumen paint.

1000mm Wide Alkali Resistant Mesh Centered Along Intersecting Walls and Floors

Depth of Tradical® Hemcrete® to suit thermal performance required

5/8" Baunit FL68 Lime Render direct to Tradical® Hemcrete®

External Finish:
1/8" Pre-colored Baunit SEP Lime Render Top Coat

EXTERIOR

Depth of Tradical® Hemcrete® to suit thermal performance required

Scrim cloth or mesh to corner junction of wall and ceiling

3/8" U.S. Heritage Group HS-B Hydraulic lime plaster base coat

Internal Finish Options:
1/8" U.S. Heritage Group HS-F Hydraulic Lime Stucco/Plaster Finish Coat with 3 coats limewash or tint plaster to final finish color.

Wood frame and bracing requirements to architect's specification

INTERIOR

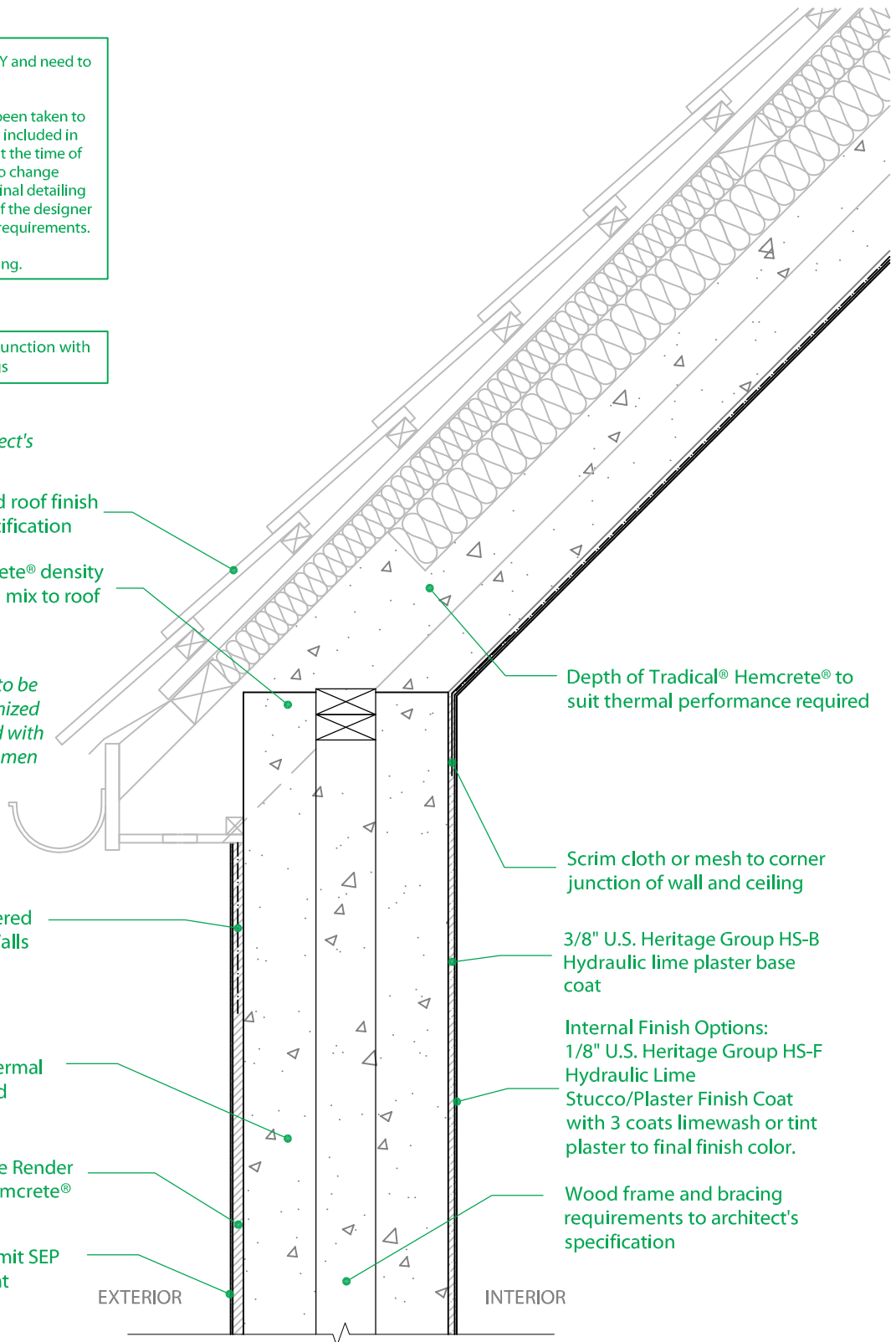

12.11	US Conversion	UK File Name	DWN	CKD
	ALT]TradHem]Render]TRAD_WRM_ROOF	LT_H_1_05_WRF		
			JK	DW